

## 11. 尺寸信息 Dimension information

中心高公差  
Shaft heights tolerances

h ≤250mm → -0.5mm  
h >250 → -1mm

地脚安裝減速機：當配有電機時，電機可能已凸出到安裝平面以下，請注意檢查。  
Foot-mounted gear units: The motor may project below the mounting surface when fitted, please check.

軸公差  
Shaft tolerance

直徑公差 Diameter tolerance

Φ ≤50mm → ISO k6  
Φ >50 → ISO m6

按照DIN332標準有DR型中心孔：

Center hole in accordance with DIN332.  
shape DR

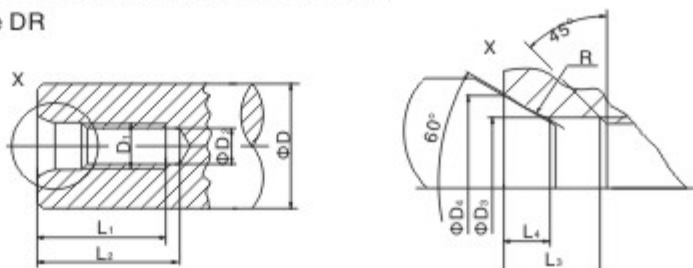

輸出軸直徑ΦD Diameter of Output shaft	D1	D2	D3	D4	R	L1 +2	L2 min	L3	L4 ≈
ΦD=7-10mm	M3	2.5	3.2	5.3	4.0	9.0	12.0	2.6	1.8
ΦD>10-13mm	M4	3.3	4.3	6.7	5.0	10.0	14.0	3.2	2.1
ΦD>13-16mm	M5	4.2	5.3	8.1	6.3	12.5	17.0	4.0	2.4
ΦD>16-21mm	M6	5.0	6.4	9.6	8.0	16.0	21.0	5.0	2.8
ΦD>21-24mm	M8	6.8	8.4	12.2	10.0	19.0	25.0	6.0	3.3
ΦD>24-30mm	M10	8.5	10.5	14.9	16.0	22.0	30.0	7.5	3.8
ΦD>30-38mm	M12	10.2	13.0	18.1	20.0	28.0	37.0	9.5	4.4
ΦD>38-50mm	M16	14.0	17.0	23.0	25.0	36.0	45.0	12.0	5.2
ΦD>50-85mm	M20	17.5	21.0	28.4	31.5	42.0	53.0	15.0	6.4
ΦD>85-130mm	M24	21.0	25.0	34.2	40.0	50.0	63.0	18.0	8.0
ΦD>130mm	M30	26.5	31.0	42.6	50.0	63.0	85.0	20.0	10.0

空心軸  
Hollow shaft

鍵：根據DIN6885確定（圓頭平鍵）  
Keys: In accordance with DIN6885(domed type)  
直徑公差  
Diameter tolerance

Φ → ISO H7塞規測量  
ISO H7 measured with plug gauge

花鍵軸  
Multiple-spine shafts

Dm = 測量棒直徑 Measuring roller diameter  
Me = 檢測尺寸 Inspection size

**法蘭  
Flange**

止口公差 Centering shoulder tolerance

 $\Phi \leq 230\text{mm}$  ( flange size A 120–A300 ) →ISOj6

 $\Phi > 230\text{mm}$  ( flange size A 350–A660 ) →ISOh6

對於每個規格的斜齒輪減速機、交流(制動)電機和防爆(制動)電機最多可提供三種不同尺寸的法蘭，每種法蘭的尺寸見相關尺寸表。

Up to three different flange dimensions are available for each size of helical gear units AC (brake) motor and explosion-proof AC (brake) motor. The possible flanges per size are indicted in the relevant dimension sheets.

**起吊螺栓及吊耳**
**Lifting eyebolts, suspension eye lugs**

RCR17和RCR27減速機，電機機座號小於100的減速電機沒有配備專門的運輸吊裝工具、其它的減速機和電機配有鑄造的吊裝孔，用螺栓固定在機體上的吊耳或吊環。

RCR17...RCR27 helical gear units, motors up to DV100 and Spiroplan geared motoes are delivered without special reansport fixtures. Otherwise, the gear units and motors are equipped with cast-on suspension eye lugs, screw-on suspension eye lugs or sceew-on lifting eyebolts.

減速機/電機型號規格 Gear unit/motor type	吊環/吊耳 Screw-on lifting eyebolts /suspension eye lugs	鑄造吊裝孔 Cast-on suspension eye lugs
RCR/RF37-57,RCRX/RXF57-67	●	—
≥RCR67	●	—
RCF37-157	—	●
RCK37-157	—	●
RCK167-187	●	—
RCS37-47	●	—
RCS57-97	—	●
≥D112	●	—

**通氣閥**
**Breather valves**

減速機尺寸圖總是顯示為螺塞，相應地螺塞在出廠前按照其定貨要求的安裝位置更換為通氣閥。這意味着減速機的外形尺寸圖稍有不同。

The gear unit dimension drawings are always shown with screw plugs. The corresponding sc-rew plug is replaced by an breather valve at the factory depending on with mounting position M1–M6 is ordered. This means the contour dimensions may be slightly different.

**鎖緊盤連接**
**Shrink disk connevtion**

對於鎖緊盤連接的空心軸減速機：若需要可向我公司索要關於鎖緊盤的詳細數據表。

Hollow shaft gear unit with shrink disk connection: If required, please request a detailed data sheet on shrink disks form company, data sheet no.33 753..95.

**花鍵空心軸**
**Splined hollow shaft**

RCFV..和RCKV..減速機從37到107可提供按DIN5480制作的花鍵空心軸。

Hollow shaft gear units RCFV.. in sizes 37–107 and RCFV.. In sizes 37–107 are supplied with a splined hollow shaft to ISO4762.

**RCFA/RCFH/RCFV的橡膠緩衝墊**
**Rubber buffer for RCFA/RCFH/RCFV**

 f為在力矩 $M_{amax}$ 作用下橡膠緩衝墊被壓縮的距離尺寸

 f stands for the compressed dimension of Rubber buffer in the  $M_{anax}$  torque.

**制動電機**
**brake motors**

配制制動電機時，G1B的尺寸代替G1；KB代K

In brake motors, dimensions G1B apply instead of G1 and KB instead of K

**電機附件**
**Motor accessory**

電機的尺寸因不同的電機附件而不同，請參考電機選擇的尺寸圖。

The motor dimensions may different as a result of motor accessory. Please refer to the dimensions of the motor accessory.

**特殊應用**
**Special versions**

接線盒的尺寸，在特殊應用如KS或CSA時與標準形式的尺寸不同。

The dimensions of the terminal box on special versions such as KS or CSA may different form the standard dimensions.